

INTRODUCTION

Congratulations on your purchase of a Batrie Dollhouse.

Your dollhouse has been precision crafted in Vermont with meticulous care by our craftspeople, using only the finest quality materials.

Take your time during assembly and be sure to read the instructions completely before you proceed.

This dollhouse will last for years, even generations, if proper care and attention is given during assembly.

HELPFUL HINTS

Always read through all assembly instructions before assembling the house.

Do not skip steps. Follow the instructions in the defined sequence.

- Arrange pieces in groups ready for assembly. Following the assembly instructions, assemble enough in a dry run to be sure you know ahead of time when and how each part fits. Always be sure of the parts orientation before gluing.
- Sand any rough edges or splinters before gluing.
- Always wipe off excess glue immediately.
- Make all joints flush. Keep surfaces and edges square.
- Occasional changes in humidity can cause all woods to expand or contract slightly. Always "dry-fit" parts before gluing. Limited sanding or clamping may be required for proper fit.
- All Batrie dollhouse kits are inspected before shipment. However, climatic changes and handling during shipment may cause defects.

If this occurs and there is sufficient time for us to replace the part, please contact our Service Department for replacement. Write:

Real Good Toys
Customer Service Department
P.O. Box 706
Montpelier, VT 05602
(802) 479-2217

Be sure to include explicit identification and measurements taken directly from the parts list for replacement parts.

Most repairs can easily be made by the kit builder. Warped parts are usually self-straightening during assembly.

- A large, clutter-free, well lighted work area is most helpful during assembly.
- Before you begin to assemble the dollhouse, it will be helpful to have the following materials handy:

White glue (Elmers)
Elastic Bands
Masking Tape
Sandpaper (Medium grit)
Pencil
Ruler

- It will be necessary to use weights when gluing to insure proper adhesion and minimize slippage. Books or other flat household objects work very well as weights in these situations.
- Read the instructions carefully, look at the illustrations and photograph on the box, and think the assembly through before you proceed.
- Identify and familiarize yourself with all the items in the kit.
- You may wish to paint all trim and clapboard prior to assembly.

#1287 CAPE DOLLHOUSE KIT

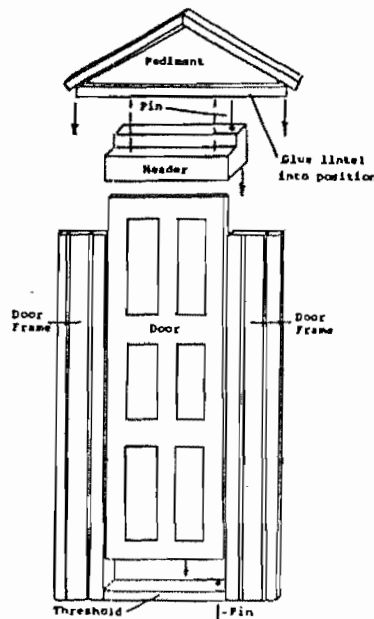

DOOR ASSEMBLY
DIAGRAM

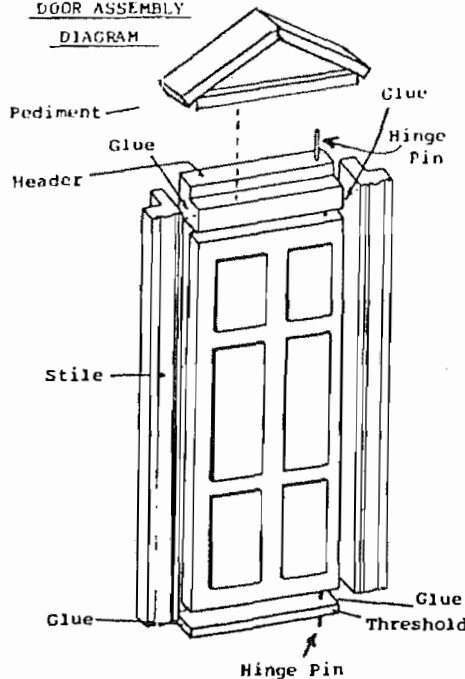

Parts List

- 1 Roof top 23-7/8 x 8-1/2"
- 1 Base floor 23-3/8 x 15-7/8
- 1 Second floor 23-3/8 x 15-7/8 (stairway hole)
- 1 Front roof 23-7/8 x 11-7/8 45° beveled top edge
- 1 Stairs die cut
- 400 Wooden shingles
- 1 Door pack
- 2 MH6020 windows
- 1 Divider 9-7/16 x 12-7/16 (doorway)
- 2 Attic partitions 8 x 15-7/8 (45° angle)
- 2 Gable liners 1/8 x 8 x 15-9/16
- 2 Corner connectors 9-7/16 (2 1/4" grooves)
- 2 End cap 9-7/16 (1/4" groove)
- 2 Gable end cap 8" (3/8" groove)
- 4 Porch posts 1/2 x 1/2 x 9-7/16 (no groove)
- 4 Rails 7-9/16
- 1 set Gingerbread 7-9/16 (left and right)
- 1 Gingerbread 5-15/16
- 4 Rails 2-3/8
- 1 set Gingerbread 2-3/8 (left and right)
- 30 Dowels 1-3/4

Part

Clapboard:

A	1	22-9/32
A1	1	22-9/32 with grooved lower portion
F	10	12-1/8
F1	2	12-1/8 with grooved lower portion
F2	2	12-1/8 with tongued upper portion
D	2	9-19/32
D2	2	9-19/32 with tongued upper portion
C	6	4-11/32
B	6	2-23/32
1 Pack attic end wall clapboard - 10 angled clapboard pieces		

1) FRONT DOOR ASSEMBLY

Assembly instructions for the standard Batrie door:

- Refer to the Assembly Diagram and identify and arrange the door parts.

- Apply glue to each end of both the header and threshold.

Check parts orientation before gluing.

NOTE: The pre-drilled hole in the header and threshold should be at the right side.

- Assemble the parts as shown in the Diagram and wrap securely with elastic bands around each end of the frame.

Check to see that the door frame is secure and the header and threshold flush with the sides of the frame.

- After the glue has dried, install the door.

The door has a beveled edge, the beveled edge is the "hinge" on the right side and permits easy opening and closing.

- Using the nails provided in the hardware kit push the shorter nail through the hole in the threshold and into the door.

The longer nail goes through the header.

NOTE: Be sure to center the nails to avoid splitting the door.

- Finally, glue the decorative door pediment, if required, into place as shown in the Assembly Diagram.

- If too tight during assembly, sand or file the corners to fit.

#1287 Pg. 1

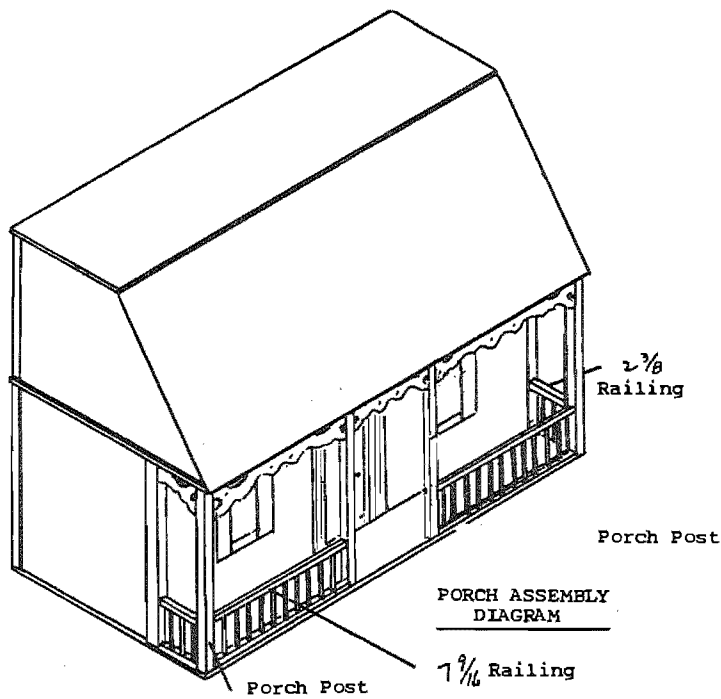

6) POST AND RAILING ASSEMBLY

- a) The rail assemblies should now be assembled. Use the illustrations to identify the proper orientation of rail assemblies.
- b) For each pair of railings mark location of spindles every 7/8".
- c) Apply a dab of glue to the bottom of each spindle and install as shown.

Be sure all spindles are perfectly upright and perpendicular. Install the top railing only after the spindles have dried.

- d) After all the railing sets have been completed, install them into position on the dollhouse, using the 9-7/16" porch posts and gingerbread. (Gingerbread is supplied in the same lengths as railings.)

Use Diagram for correct orientation. The posts are installed by merely applying a dab of glue to the bottom of each post.

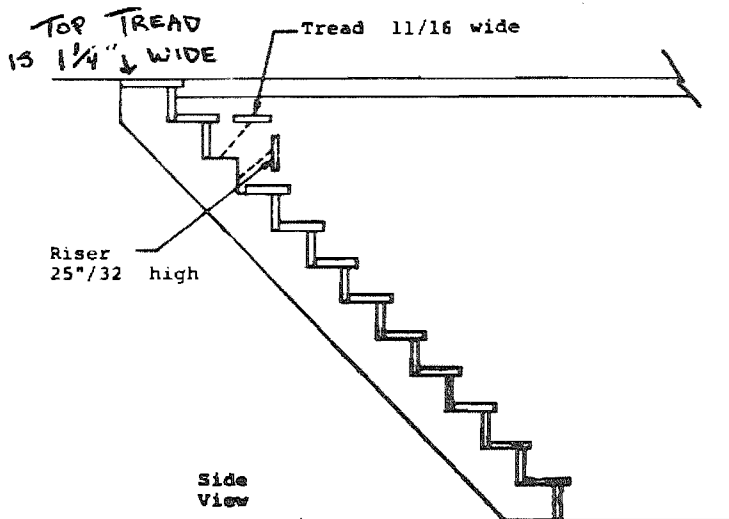
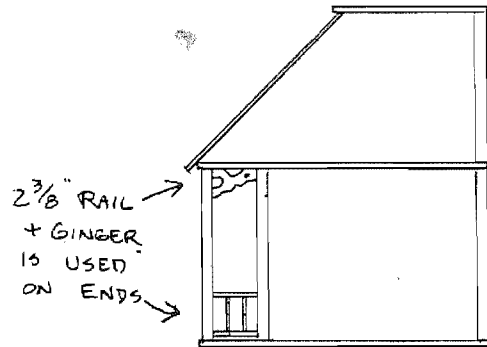
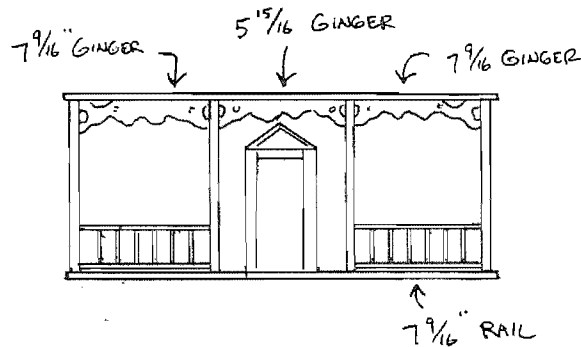
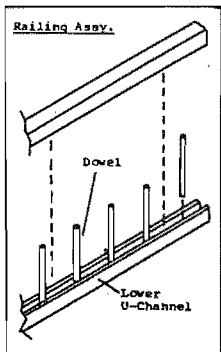

7.) ASSEMBLE STAIRS

- a) Punch out parts from die sheet.
- b) There are three stair sides. Match the two best sides.
- c) Glue on 2nd from top and bottom stair backs. Stair backs must be flush with tread surface. Trim or elevate if necessary.
- d) Glue on the rest of the stair backs. The top stair back should protrude.
- e) Glue on the treads, except the top tread.
- f) Square out the front edges of the stair hole.
- g) Glue the top tread into the hole, flush with the floor surface.
- h) Glue stair unit into position.

8.) We recommend temporary placement of dividers, using rubber cement or dots of glue so that they can be easily removed for interior decoration. See diagram.

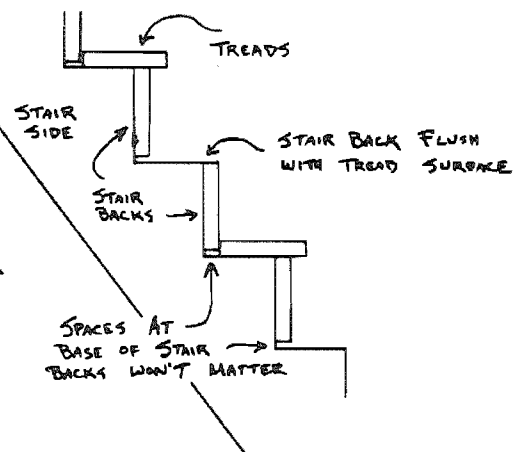
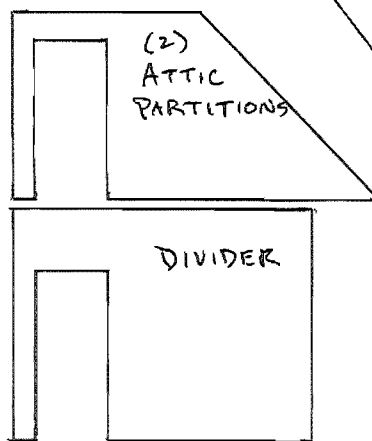
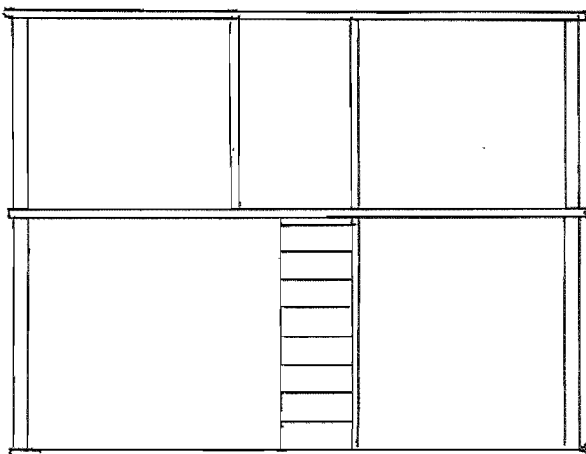

SUGGESTED ROOM LAYOUT

9.) SHINGLE THE ROOF

- a) Wooden shingles provided are enough to cover all roof surfaces except the top roof panel.
- b) Use a 1" reveal on all roof panels.

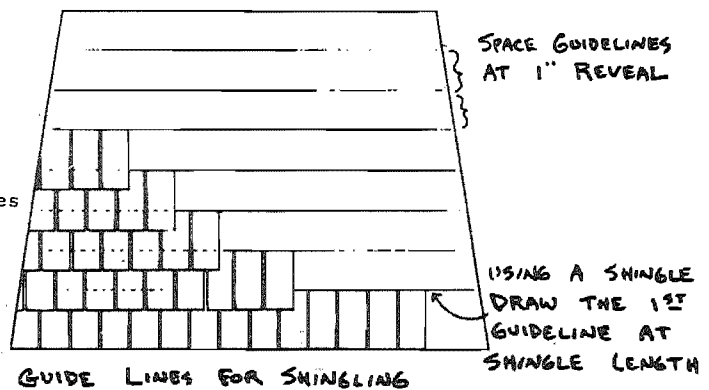

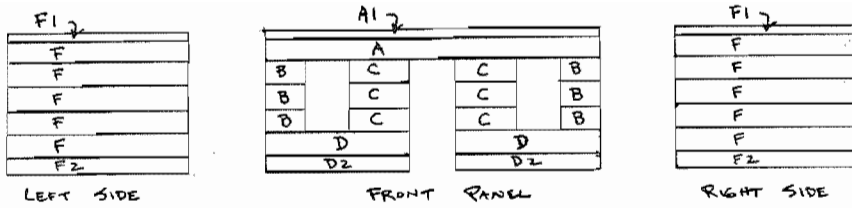

#1287 CAPE DOLLHOUSE CLAPBOARD ASSEMBLY

2) ASSEMBLE CLAPBOARD WALL SECTIONS

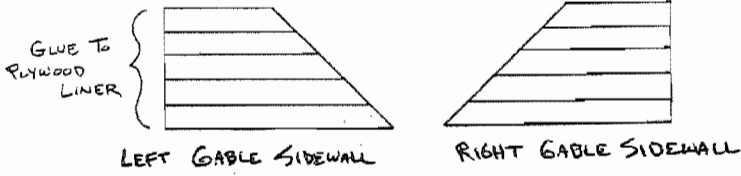

- Glue together wall sections as shown. It is important to make the ends square and flush. "One clapboard" section (with no tongue) is used at the top of the wall. "Two clapboard" sections (with no groove) are used at the bottom of the walls.
- Use the window and door assemblies to ensure proper spacing.
- Use lots of rubberbands and weight the wall sections while drying.

#1288 ADDITIONAL STORY (OPTIONAL) CLAPBOARD ASSEMBLY

3) ASSEMBLE HOUSE BODY

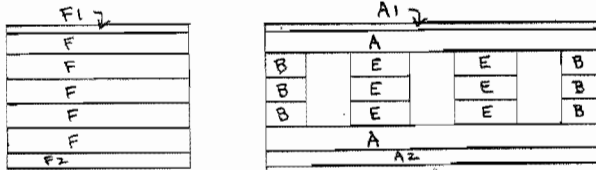

- Following the diagram showing the proper orientation of connectors and wall sections, assemble these parts without glue (dry-fit) in position on the base floor. Use masking tape. Assembly is flush at rear and evenly spaced side to side.
- When satisfied with this assembly trace outline. Then starting at one end reassemble with glue.
- Glue 2nd floor panel in place evenly spaced. Use weight and tape. Make sure rear edge of end wall sections are flush at rear, and that everything is set square.

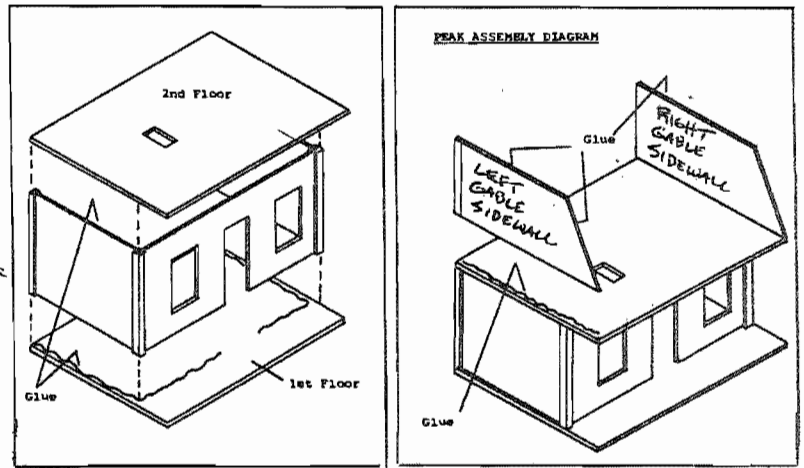
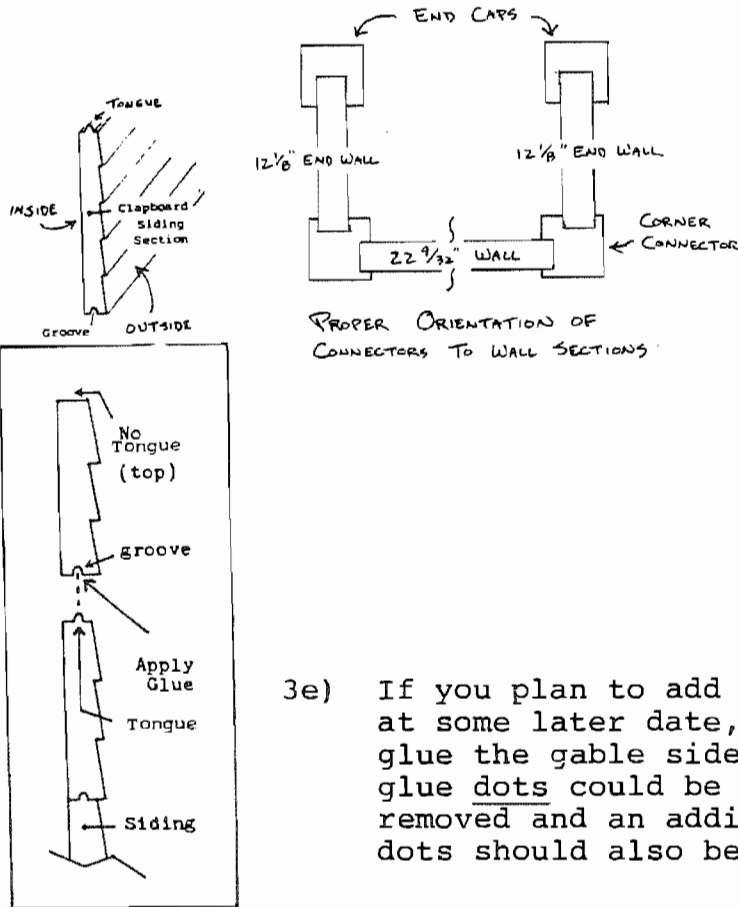

- If you are using additional stories for your dollhouse, repeat steps 3.a) through 3.c) following the second story diagram for clapboard assembly. This design allows you to add as many additional stories as you wish. See your dealer for details.

- 3e) If you plan to add additional stories to your dollhouse at some later date, use only dots of glue in step #4 to glue the gable side walls into position. Later these glue dots could be broken so that roof assembly could be removed and an additional story could be added. (Glue dots should also be used on bottom edge of attic partitions.)

ROOF ASSEMBLY DIAGRAM

4) ROOF ASSEMBLY

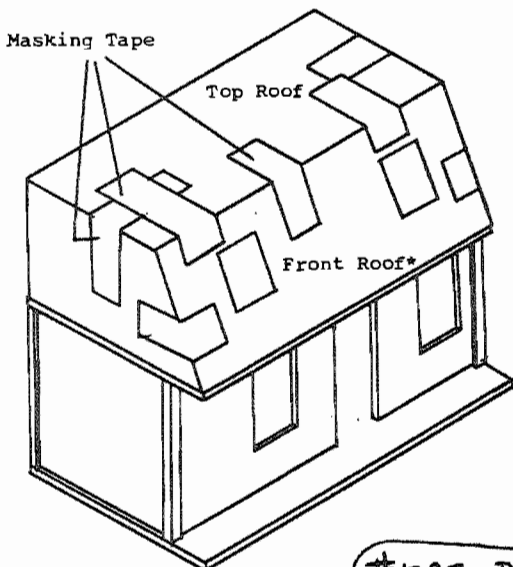

- Assemble the gable sidewalls as shown ABOVE.
 - There are 5 angled clapboard pieces for left end wall and 5 angled clapboard pieces for the right.
 - Thoroughly glue these clapboard pieces to the rougher side of plywood liners.
 - Attach the 8" 1/4 x 1/4 end cap with 3/8" groove over the square end of this assembly.
- Glue gable sidewalls into position on house directly above the side panels. Line up the end caps. Use the attic partitions to prop end wall.
- Glue the front roof panel into position centered side to side with bevel at top edge flush with gable sidewall top edge.
- Glue the top roof panel in position, flush at the rear edge, centered side to side. The top roof should be lightly weighted down to assure good adhesion. (Temporarily install angled partitions to support weight while glue is drying.)

Note: You may wish to wait and install the top roof panel after shingling.

5) PRE-ASSEMBLED WINDOWS AND DOOR

Install the pre-assembled windows and door in the appropriate openings. The tongue of the exposed clapboard siding must be trimmed.