

AH130

ASHLEY ASSEMBLY INSTRUCTIONS

Congratulations on selecting a miniature house kit manufactured by Dura-Craft, Inc., the leader in the industry. We pride ourselves in our high quality and workmanship. Each piece is graded and sanded at several different stages to ensure that you receive the finest quality.

A Dura-Craft miniature house is a complete kit. You will not have to make separate purchases of items like the windows and shingles which are a basic part of your house. Your finished house will be ready for painting, wallpapering and decorating.

Your finished house will be of heirloom quality, of which you will be justly proud, if ample time and care are used in its construction and finishing.

READ THIS BEFORE STARTING ASSEMBLY

The following tips will help you avoid problems when you build your miniature house.

1. **Save the box** The photo will be very helpful during assembly.

2. Do not remove any pieces from their punch sheet before they are called for in the instructions. This will reduce part warpage and make part identification easier. But, if you plan to paint your house it is easiest to paint all parts before assembly. If you plan to do this we recommend that wood be glued to wood. That means if all parts are painted, the areas where glue will need to be applied will need to be masked with tape or scraped later.

3. Read through the instructions carefully once to get a feel for the assembly process and to gain familiarity with the parts.

4. Follow the instructions in order.

5. **If you cannot release a part from its board with moderate pressure, then carefully cut it loose with a utility knife. Always cut from the good side of the board where the cut lines are clearly visible.**

6. If any parts are missing or damaged, they can be quickly replaced by Dura-Craft. Please write or call and give us the name and sheet number of the part or parts that you need. We have included a "Missing and Broken Parts Replacement Form" to assist you. It may save time to make missing or broken parts from the scrap material.

7. We recommend the use of Aleene's Tacky Glue to construct your house. This glue helps hold parts in place while it dries, and it dries clear. It can be found at most craft supply stores. Any white household glue or woodworking glue may be substituted if desired. Wipe away excess glue while it is still fresh.

8. Dura-Craft has done everything possible to ensure that your kit will look good when it is complete. We have included pine moldings to strengthen the house and trim to cover all of the outside wall and floor edges, and we have designed the kit so that slot and tab positions will be hidden when the kit is finished. However, the final quality of your house will depend to some extent on the care you take in preparing each piece for assembly. Sanding is optional, but it will improve your house. It will also remove splinters from the edges of the parts which will help the parts fit better.

9. You will need the following materials to assist you in the assembly of your miniature house:

- Glue (see paragraph 7 above)
- Utility knife - sharp, sturdy knife
- 3/4" masking tape
- Damp cloth
- Ruler or tape measure
- Fine toothed saw such as a coping or hacksaw is helpful
- Pencil
- 100 grade (med.) sand paper
- A roll of waxed paper

GLOSSARY

- Good side- The side the pieces were stamped from. The smoothest side.
- Bead of glue- A line of glue about as large as a pencil lead.
- 1/8" - inches.
- Flush- When the edges of two boards are even.
- Left and right sides- All references will be made from the front view, unless otherwise instructed.
- Tab- A projection off the edge of a board.
- Slot- A hole in a board that a tab fits into.
- Notch- The same as a slot, except it's on the edge of a board.
- Glass- Silkscreened plastic sheets.

INVENTORY LIST

Part No. AH-1 through AH-9
9 stamped sheets of parts (see back of instructions)

1 silkscreened sheet of windows

Part No. 6-34

41' universal trim (3/32"x5/16")

Part No. 5-3

4' small edge trim

Part No. 5-70

50" small corner post

Part No. S5-2

2 door knobs

Part No. 6-17

8" of 1/4" dowel

Part No. 5-143

AH 130 ASHLEY ASSEMBLY INSTRUCTIONS

1. Locate the walls with windows, including **Bay Wall, Front Wall, and Dormer Walls** (Sheet AH-3,4,7). Lay the parts on a table with the good sides up. Cut to fit **Universal Trim** to surround all window openings **except** the door opening and door side windows. See Figure 1.

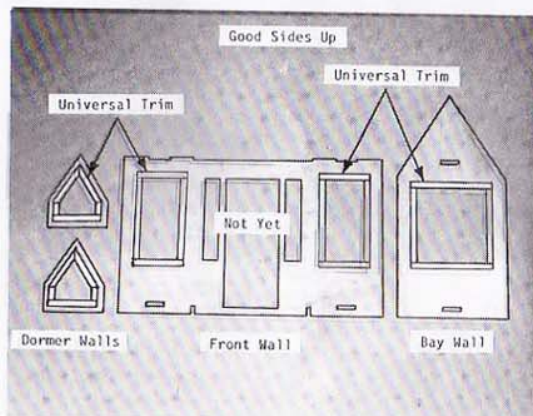

Figure 1

2. Turn Walls over. Locate **Window Glass**. Cut out Bay Window, Dormer Windows, Front Wall Windows. Run a small bead of glue around the window openings and spread with finger. Place window glass on wall with the whitest side down. Make sure glass is centered on opening. Again cut to fit **Universal Trim** to surround the window openings **except** the door and door side windows. See Figure 2.

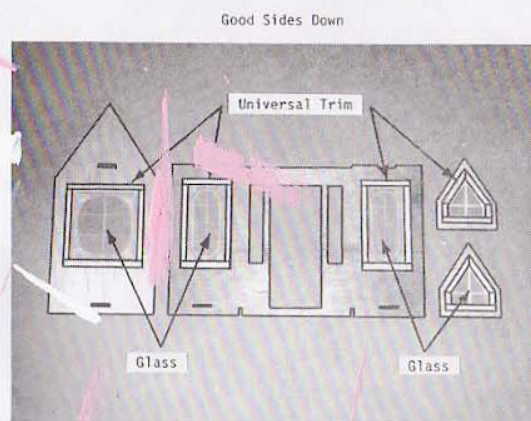

Figure 2

3. Locate **Left Wall, Right Wall** (AH-2,3) and **Bay Wall**. Lay them on the table with the good side up. Temporarily tape S5-2 and 5-70 to the edges. With the bottom edges flush, cut the S5-2 and 5-70 along the same angle as the slope of the gable. Glue in place. Make sure the S5-2s are squarely glued in place. See Figure 3.

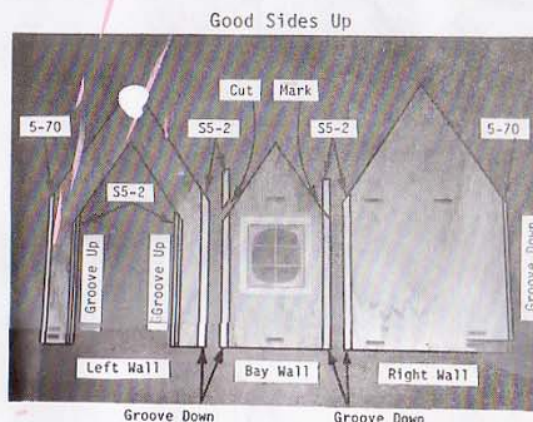

Figure 3

4. Glue the front wall (with the good side out) into the grooves of the S5-2 on the Right and Left Walls as in Figure 4.

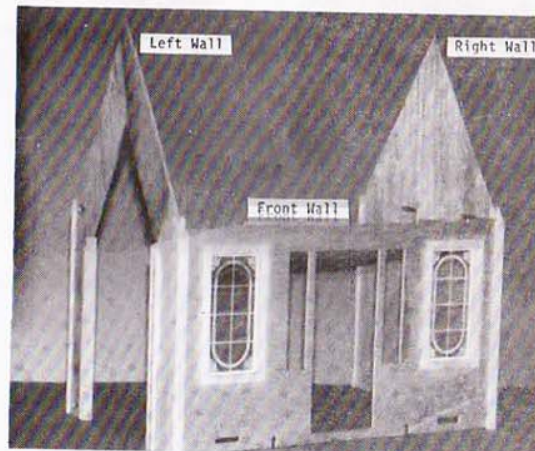

Figure 4

5. Locate **1st Floor and Bay Floor** (AH-1,4). Lay floors good side down. Line up parts and tape together. Turn parts over so good side is up. Run a small bead of glue in the junction crack. Wipe away excess glue and tape together. See Figure 5.

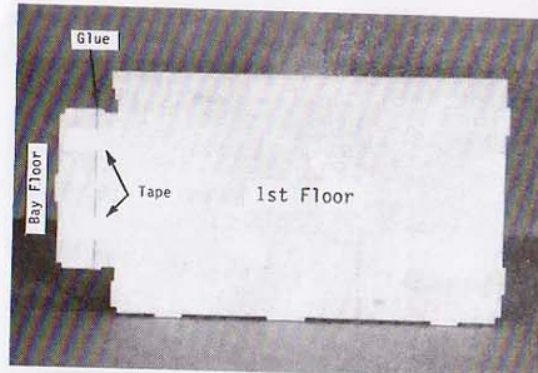
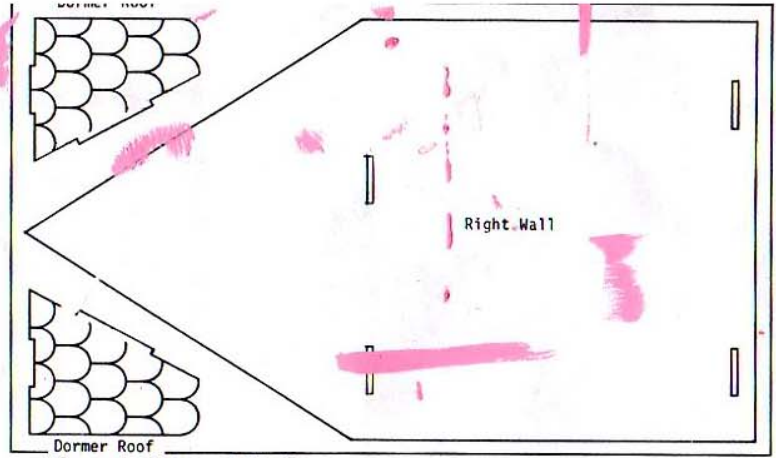

Figure 5



Sheet No. AH-1



Sheet No. AH-2

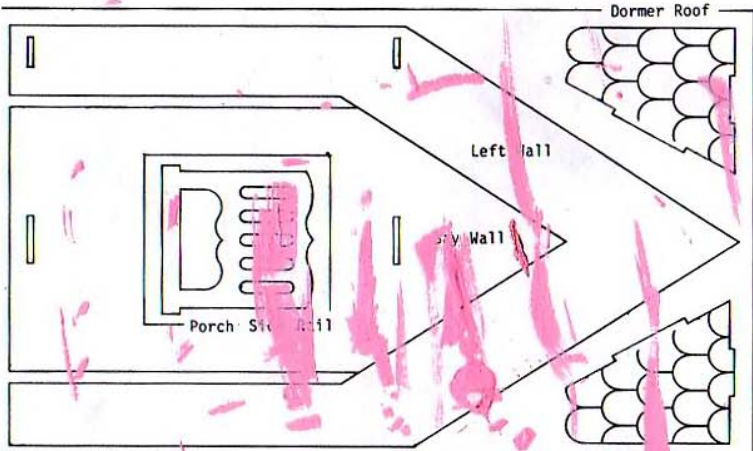

Sheet No. AH-3

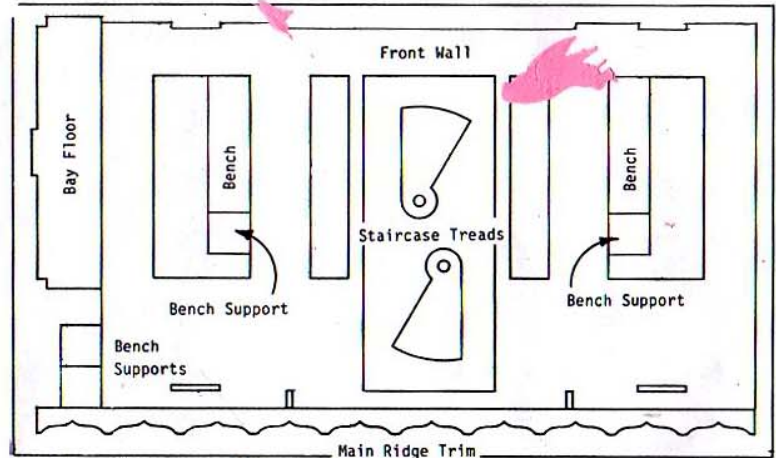

Sheet No. AH-4

Content missing - sorry!



Sheet No. AH-5

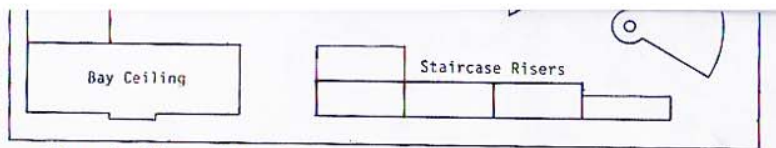

Sheet No. AH-6

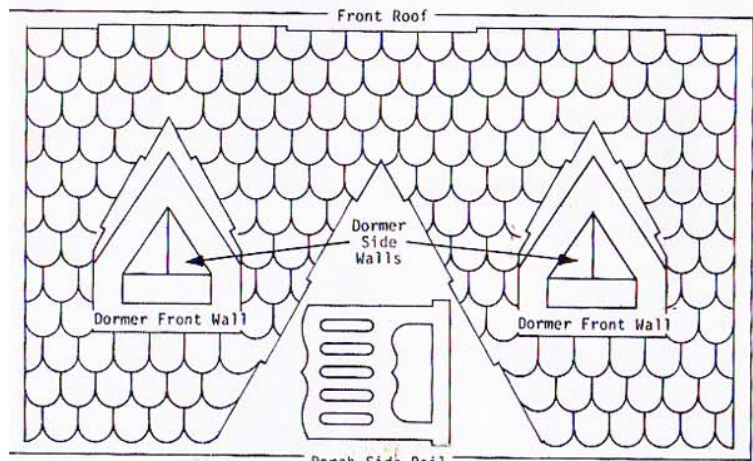

Sheet No. AH-7

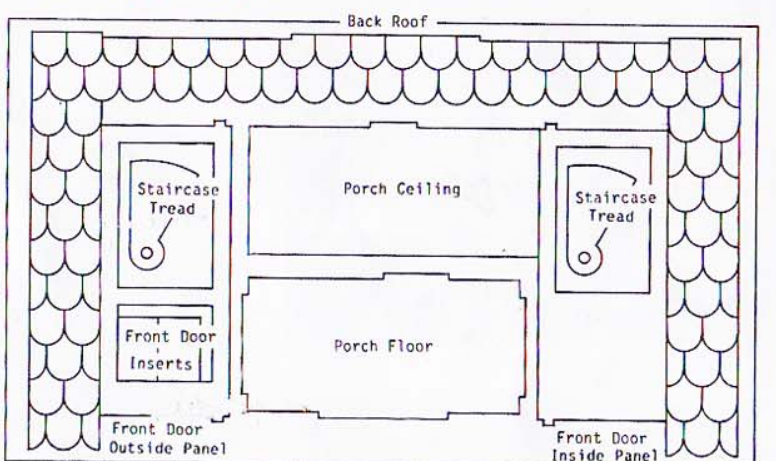

Sheet No. AH-8

CH PART IS HELD IN THE BOARD BY NOTCHES, THESE NOTCHES MUST BE CUT BEFORE REMOVING PARTS FROM THE BOARDS.

Dura-Craft, Inc.
 P.O. Box 438
 Newberg, OR 97132
 (503) 538-3136

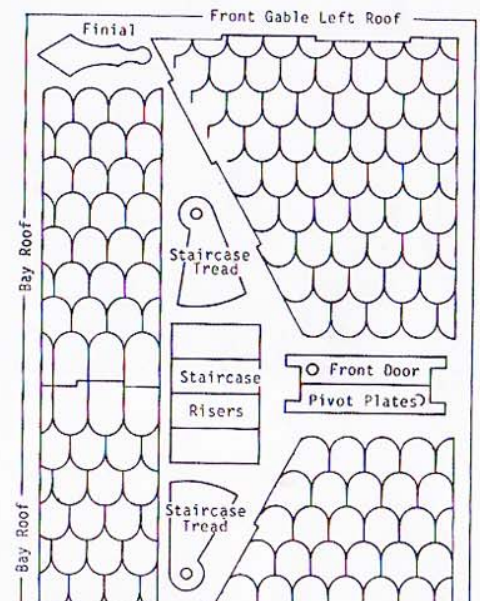

Tape 1st floor assembly into walls. Tape rough the wall slots to the underside of the 1st floor. After securely taped together, run bead of glue underneath the floor along the junction of the walls and the 1st floor. See Figure 6.

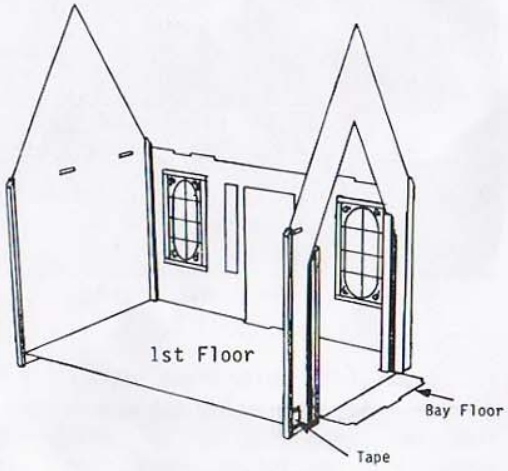

Figure 6

10. Locate **Bay Side Walls** (AH-6). Sand edges of Bay Side Walls well. Glue Bay Side Walls into grooves on Left Wall, then glue Bay Wall onto Bay Side Walls. See Figure 7.

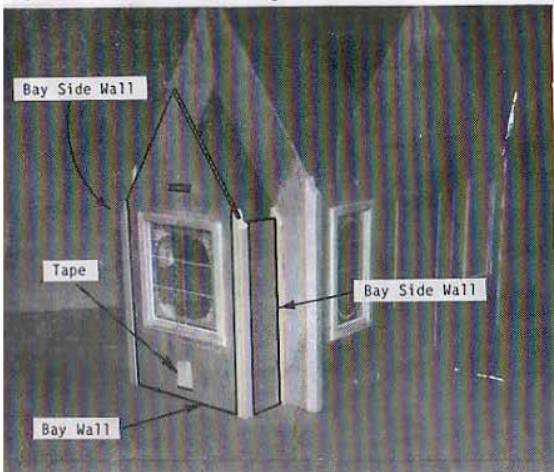
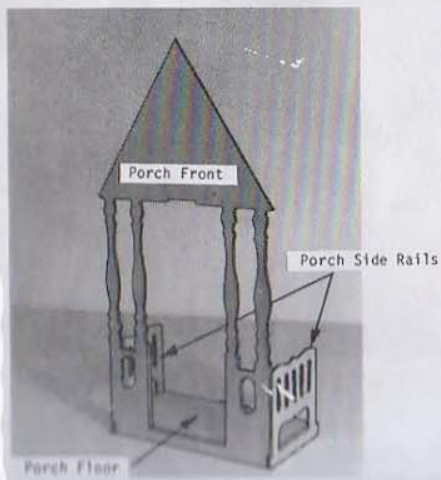

Figure 7

11. Locate the **Porch Side Rails, Porch Front, and Porch Floor** (AH-3,6,7,8). Assemble as in Figure 8. Notice the widest tab of the Porch Floor goes in the Porch Front.



12. Locate **Bench Supports and Benches** (AH-4). Assemble as in Figure 10 and glue in place. See label.

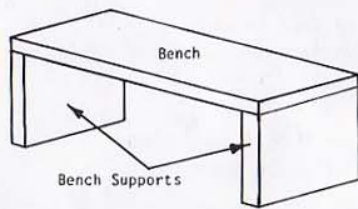

Figure 10

13. Locate **Front Door Inside Panel, Outside Panel, Pivot Plates, and Front Door Inserts** (AH-8,9). Lay the Inside Door Panel on the table with the good side down. Glue **Front Door Glass** to bad side of Inside Panel like the other windows. Add glue to the bad side of the Outside Panel, set Outside Panel on Inside Panel. Make sure edges of panels are flush and pivot pins are lined up. Glue Front Door Inserts into openings of Outside Panel. See Figure 11.

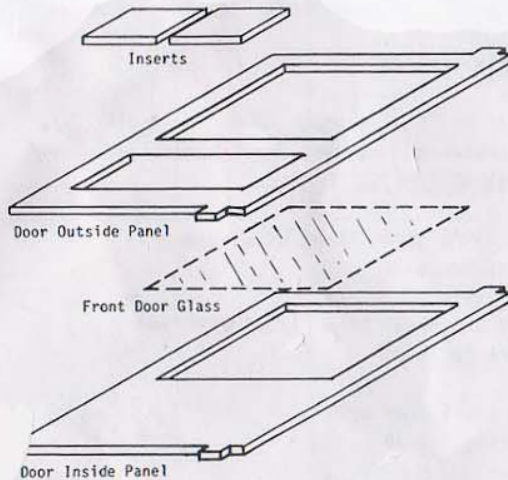
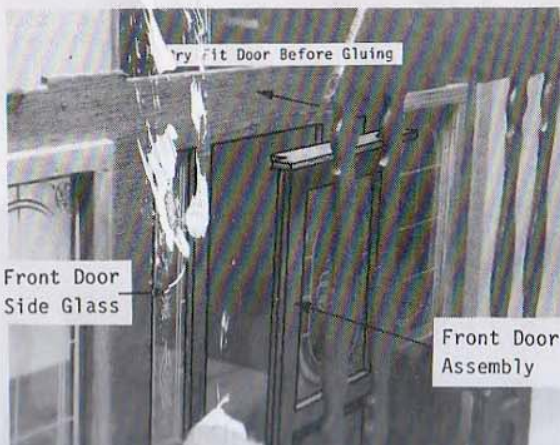

Figure 11

14. Sand the Pivot Pins round so they fit into the holes in the Pivot Plates. Before gluing the Door assembly in place, put the Pivot Plates on the door and insert into the door to check for proper fit. Sanding may be required for smooth operation. Glue **Front Door Side Glass** in place on each side of the front door. See Figure 12. Cut Universal Trim to fit on the sides and the top of the door opening and the door side windows both inside and out.



15. Glue **Second Floor** in place as in Figure 14.

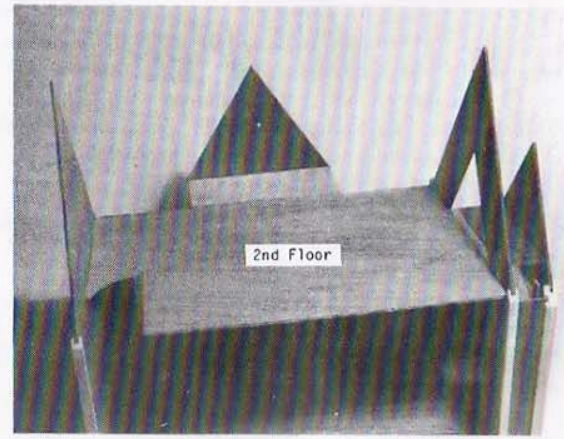

Figure 14

16. Locate **Front Roof, Dormer Side Walls** (AH-7) and relocate Dormer Front Walls. Assemble as in Figure 15.

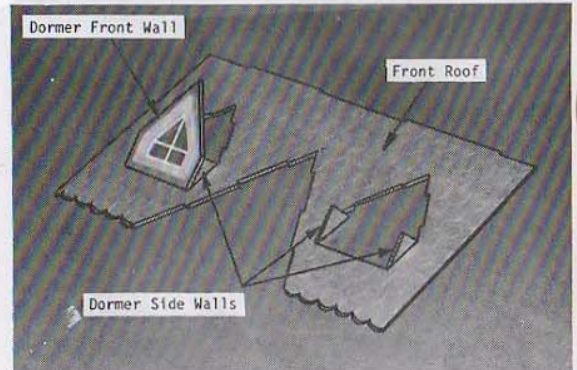

Figure 15

17. Locate **Front Gable Left and Right Roofs, and Dormer Roofs** (AH-2,3,9). Interlock and glue to Front Roof as in Figure 16.

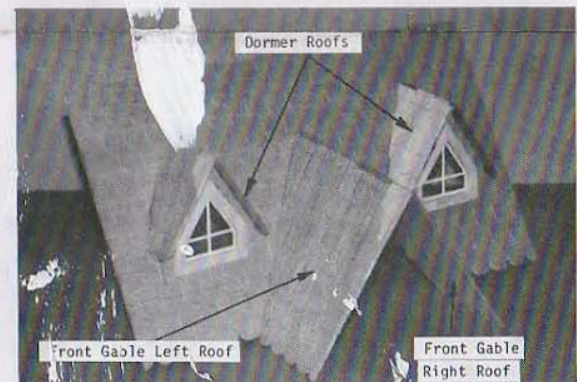

Figure 16

18. Locate **Back Roof** (AH-8). Glue Back Roof and Front Roof assembly to gables of house as in Figure 17.



Content missing - sorry!

